

# Polyurethane Scraper Cups

Replacement Parts for Steel Mandrel Pipeline Pigs  
 by Girard Industries & other manufacturers

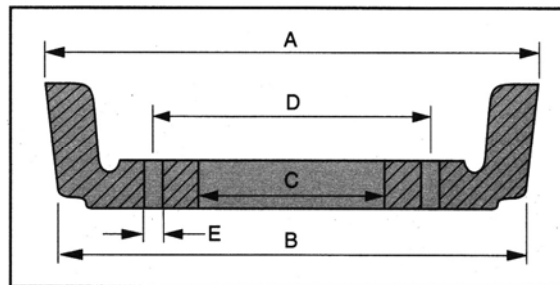
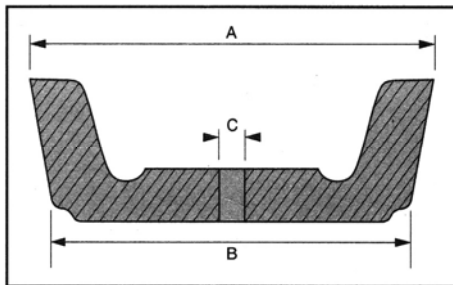

- Made of liquid cast polyurethane.
- High tear strength.
- Outstanding cut and abrasion resistance.
- Center hole and bolt circle can be modified to fit most pig bodies.
- Various durometers to fit different applications.

Size	A	B	C	D	E	Approx. Weight
	Trailing Edge OD	Leading Edge OD	Center Hole	Bolt Circle	Bolt # - Size	
2"	2 1/4"	1 1/2"	3/8"	n/a	n/a	0.1 lbs
3"	3 1/4"	2 3/4"	9/16"	n/a	n/a	0.2 lbs
4"	4 1/4"	3 3/4"	9/16"	n/a	n/a	0.3 lbs
4" TW	4 1/2"	3 3/4"	9/16"	n/a	n/a	0.4 lbs
6"	6 5/16"	5 1/2"	1 1/16"	n/a	n/a	1.0 lbs
6" TW	6 1/2"	5 1/2"	1 1/16"	n/a	n/a	1.1 lbs
8"	8 3/8"	7 5/8"	1 1/16"	n/a	n/a	2.2 lbs
8" TW	8 5/8"	7 5/8"	1 1/16"	n/a	n/a	2.4 lbs
10"	10 3/8"	9 3/8"	1 1/16"	n/a	n/a	3.5 lbs
10" TW	10 5/8"	9 5/8"	1 1/16"	n/a	n/a	3.7 lbs
12"	12 3/8"	11 1/2"	1 1/16"	n/a	n/a	5.0 lbs
12" TW	12 5/8"	11 5/8"	1 1/16"	n/a	n/a	5.3 lbs
14"	14"	13"	1 1/16"	n/a	n/a	7.0 lbs
16"	16"	14 7/8"	8 1/8"	11"	8 - 9/16"	9.0 lbs
18"	18 1/8"	17"	11"	12 3/4"	8 - 9/16"	12.0 lbs
20"	20 1/8"	18 3/4"	10 5/8"	13 1/2"	12 - 9/16"	15.0 lbs



6531 North Eldridge Parkway | Houston, Texas 77041, USA  
800.231.2861 | PHONE: 713.466.3100 | FAX: 713.466.8050  
sales@girardindustries.com | www.GirardIndustries.com

22"	22"	20 3/4"	10 5/8"	13 1/2"	12 - 9/16"	18.0 lbs
24"	24"	22 3/4"	13 3/4"	16 1/2"	14 - 9/16"	22.0 lbs
26"	26"	24 1/4"	13 3/4"	16 1/2"	14 - 9/16"	28.0 lbs
28"	28"	26 1/4"	16 1/4"	19 1/2"	16 - 9/16"	35.0 lbs
30"	30 1/4"	28 3/4"	16 1/4"	19 1/2"	16 - 9/16"	45.0 lbs
32"	32 1/4"	30 1/2"	16 1/4"	19 1/2"	16 - 9/16"	60.0 lbs
36"	36"	34"	22"	25"	22 - 9/16"	58.0 lbs
40"	40 1/4"	37 1/2"	22 1/4"	26"	24 - 9/16"	80.0 lbs
42"	42 1/4"	39 1/2"	24"	30"	24 - 9/16"	85.0 lbs
46"	46"	44"	32"	36"	24 - 9/16"	90.0 lbs
48"	48 1/4"	46"	32"	36"	24 - 9/16"	120.0 lbs
54"	54"	51"	40"	44"	36 - 5/8"	135.0 lbs